

## Industrial video endoscope

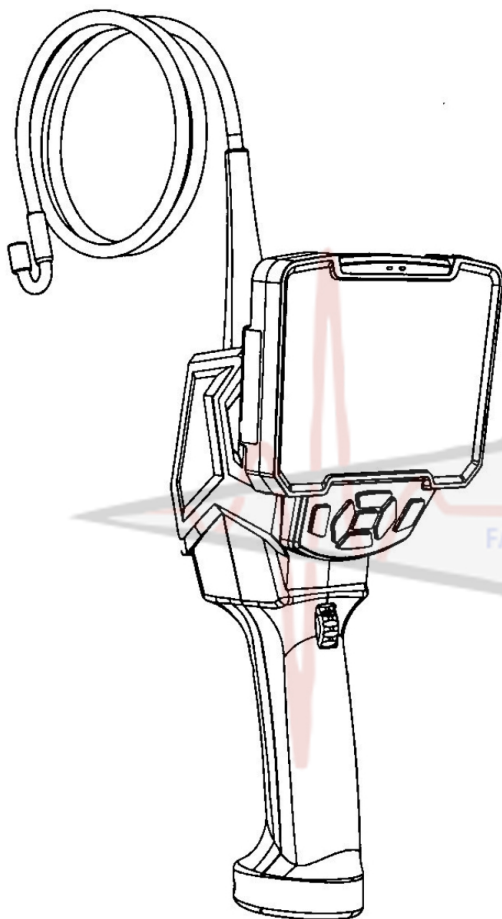

### User's manual

EN

inskam805-P

### NOTICE TO USER:

Welcome to buy this product. This product is a practical device with real-time video viewing, video recording and image capture functions. Please read the manual carefully before use:

1. Please observe the precautions described below when operating the instrument. Failure to use the instrument in accordance with regulations will not guarantee your safety
2. Do not use or store in explosive, strong electricity, magnetic field, flammable gas place, otherwise it may cause fire or explosion
3. It is forbidden to operate the detected object under the condition of electricity to avoid electric shock
4. Do not repair, disassemble or modify the instrument without authorization
5. Do not subject the product to severe impact or squeeze, otherwise it may cause damage to the internal core parts and affect the use of the product
6. Do not allow children to operate the product alone, this product must not be used for medical or human testing.
7. Do not use this product in areas that may come into contact with charged cables or charged objects. Exposed metal parts can conduct electricity, which may cause unexpected results.

EN-1

+982165565901

+982144584619

+989034119385

پتروفرهان گستر جنوب

FGJ-NDT.IR

DIGINDT.IR

## APPLICATION:

1. Tubular/water pipe cleaning: After checking the pipe, it helps to clean, rust, corrosion, dust and cracks
2. Shipbuilding industry: used to inspect boilers, steam turbines, diesel engines, pipelines
3. Industrial machinery: for checking engine wear or scars, transmission, hydraulic system, greatly reducing downtime
4. Electronics industry: used to confirm the wiring status of products, check the working status of the machine, etc.



Video



Photo



720P



4.3 Inch display



Spin



IP67(Lens)



6 LED

## PARTS LIST:

Host*1	Lens cleaning cloth*1
Rubber case*2	TF card*1
4.3 inch display*1	Product Instructions *1
USB data cable*1	

## TECHNICAL PARAMETERS:

Camera diameter	8.5MM
Camera light source	Highlight LED
Resolution	1280*720
Depth of field	20mm-60mm
Angle of view ( FOV )	70°
length	80 CM / customizable
Snake tube material	The elastic tube (customizable)
screen size	4.3 inch display
Image reversal	180°
power supply	lithium battery/2600mah
Battery working time	4 hours
interface	USB2.0
storage	TF High-speed memory card ( Minimum support 8G Maximum support 64G )
Minimum bending length	45MM
Bending angle	120 ° - 180 °
Operating temperature	0℃ - 65 ℃
Protection class	The host cannot be operated in the rain/Do not operate in water

## THE NAME AND FUNCTION OF EACH PART OF THE INSTRUMENT:

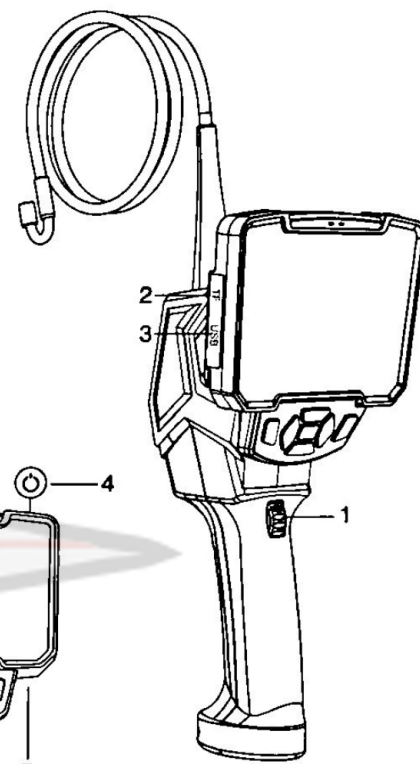

- |                       |                          |
|-----------------------|--------------------------|
| 1.trackwheel          | 7.Set key                |
| 2.TF card             | 8.Up key                 |
| 3.USB interface       | 9.DOWN key               |
| 4.Switch button       | 10.Back key/file storage |
| 5.4.3 inch LCD screen | 11.OK key                |
| 6.LED regulation      | 12.Photo/Video button    |

EN-2

EN-3

EN-4

+982165565901

+982144584619

+989034119385

پتروفرهان گستر جنوب

FGJ-NDT.IR

DIGINDT.IR

#### Terms of Use:

1. Align the connector on the back of the display with the connector on the handle, and then insert the connector on the back of the display and the connector of the host in the direction of the arrow. Until you hear a "click", it means that it has been tightened, and shake it gently with your hand.

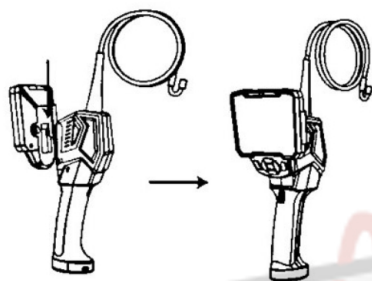

#### Instructions:

Switch button: lightly press the switch button to turn on/off.

LED adjustment: In the real-time preview interface, press to manually adjust the brightness of the LED light of the snake tube camera. There are three brightness levels. Photo button: Short press to take a photo, long press to record, and click to stop recording.

Menu button: Short press to enter the menu page, where you can set or view the resolution/date/time/date label/brightness/formatting/space/language setting/default setting/version

#### Card reading mode:

Connect the data cable to the computer and device, at this time you can view the photos and videos taken on the computer

EN-5

+982165565901

+982144584619

+989034119385

#### Using :

1. Adjust LED brightness according to actual needs
2. To adjust the bending direction and angle of the snake bone according to the actual situation, you need to press down the dial and then move it back and forth.



#### After use :

1. Power off the host
2. Remove the display
3. Turn the dial to return the front bend
4. Put in the box

#### TF card installation:

Can support a minimum of 8G to a maximum memory of 64G, FAT32 file format and TF card with a transmission speed of Class10 or higher), do not use excessive force when inserting the memory card, causing the memory card to read unsuccessfully

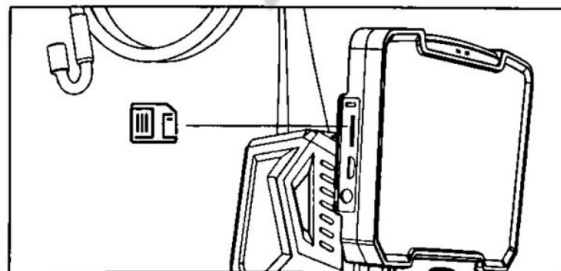

EN-6

#### Host disassembly:

First hold the handle with your hand, then pull the trigger on the back of the host up and then pull it up, you can easily disassemble the host

Press this button Extract upward to disassemble

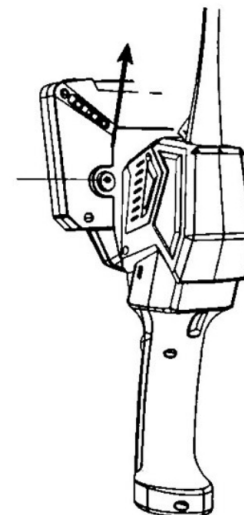

#### Endoscope use and maintenance

1. Please do not use our camera with other manufacturers' hosts without authorization, even if the interface is the same, otherwise it will burn the host.
2. The visual endoscope probe is a precision instrument. Do not touch strong acids and bases.
3. Please keep the product clean and avoid direct sunlight or direct contact with water, oil stains and corrosive liquids.
4. Please handle it gently, do not bend the coil too much.
5. Please try to use the original USB cable for charging.
6. To extend the service life of the endoscope, please turn off the power when not in use

EN-7

پتروفرهان گستر جنوب

FGJ-NDT.IR

DIGINDT.IR



#### Precautions:

1. When using the dial, first press the dial down, and then you can dial forward or backward. Otherwise, the dial will be difficult to rotate. If you force it, it may cause damage to the dial locking device and affect its use.
2. The minimum bending radius of the snake tube is 10CM. If it is smaller than this radius, it will cause damage to the internal precision parts. When the snake tube bends more, the steering mechanism will lose its corresponding function. Please do not bend the snake tube excessively.
3. If the instrument needs to be taken out of the pipe after bending, reset the steering mechanism and slowly pull out the coil. If it is forcibly removed while bending, the steering system will become abnormal and affect subsequent use.
4. The lens is a fragile part, avoid being impacted or knocked by external force during operation, otherwise the lens may be damaged and enter water

#### Charging:

When the battery power is low, the display will show "Battery Low".

, Connect the monitor to the handle to charge the device (the monitor must

Must be connected to the handle, because the device's rechargeable battery is built into the handle in). Fully charged about 4 hours, can be used normally for about 4 hours, there is a red light indicator when charging, the red light goes out when fully charged, the device will automatically shut down when charging when the power is turned on, long press the power switch can be used again (please Use a 5v /1A USB charger to charge your device.)

Indicator light: The charging indicator light on the left side is always red when charging, and automatically turns off when fully charged. The right side is the power indicator, the blue light is on after the power is turned on

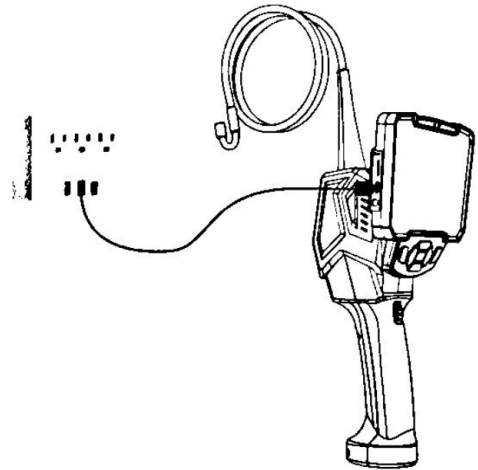

Within 1 year from the date of purchase, you will receive free warranty service if the professional maintenance personnel of the company confirm that it is damaged due to poor manufacturing process or components under normal use.

The gun body, display screen and snake tube camera are consumable parts, and the warranty is 12 months from the date of purchase. Wear caused by normal use is not covered by the warranty. During the free warranty period, the company has the right to refuse service or charge materials and assembly fees as appropriate if the following matters occur

- ① The display screen is broken due to artificial external force;
- ② Improper use or electric shock and improper installation can not be used normally;
- ③ Damage caused by illegal demolition and repair;
- ④ Intentionally destroy the warranty date;
- ⑤ Damage caused by force majeure;

\* Waste electrical products should not be disposed of with household waste, please consult your local government or retailer for recycling advice

\* There are any minor changes in the numbers contained in the user manual without notice

EN-8

EN-9

+982165565901

+982144584619

+989034119385

پتروفرهان گستر جنوب

FGJ-NDT.IR

DIGINDT.IR