

UT11A/B AC Voltage Detectors Operating Manual

This Operating Manual covers information on safety and cautions. Read and understand all of the instructions and safety information in this manual before operating or servicing this tool. Failure to understand how to safely operate this tool could result in an accident causing serious injury or death.

UT11A/B is intended to check for the presence of AC voltage, signaling the user with a beep and a flashing LED.

Safety Information

This unit complies with the standards :

EMC:EN61326-1:2006

LVD: EN61010-1:2010 EN61010-031:2002+A1:2008

UL: UL61010-1, 2nd Edition, 2005-07-22

CAN/CSA-C22.2 No.61010-1, 2nd Edition, 2004-07

measurement requirement: in pollution degree 2, overvoltage category (CAT. IV 600V).

CAT.IV: Primary supply level, overhead lines, cable system setc. Some examples include cables, meters, transformers, and other exterior equipment owned by the power utility.

Use the unit only as specified in this operating manual, otherwise the protection provided by the unit may be impaired.





- Do not use the unit if it is wet, damaged or cannot operate correctly.
- Do not apply more than the rated voltage between the probe tip and earth ground.
- When the unit working at voltage over 30V in AC, special care should be taken for there is danger of electric shock.
- Follow the local countries safety requirements and standards.

Warning

- This unit is only designed for the specialist who has certain technical knowledge to use.
- This unit is intended to check for the presence of AC voltage, the voltage range is 50-600V.
- Make sure the tested inductor possible voltage range before carrying out checking.
- When you cannot sure the tested inductor voltage range, The unit does not have any response. It does not mean the tested inductor does not have dangerous voltage, do not use any part of the body to touch the tested inductor.
- When carrying out checking, keep your fingers behind the probe tip finger guards.

International Electrical Symbols

Symbols used on the Meter and in this manual are explained below:

	Double Insulated
	Warning, Refer to the Operating Manual
	Danger of electric shock
	Conforms to Standards of European Union

Specifications

- Indicators: LED and Beep
- Voltage range: 50VAC ~ 600VAC
- Measurement Category IV 600V per IEC61010
- Temperature:
 - * Operating: 0℃~40℃
 - * Storage: -10℃~50℃
- Humidity: ≤95%
- Altitude: ≤2000m
- Pollution Degree 2
- Battery: 2 x 1.5V AAA

Operation

UT11A

Place the detector tip on or near the circuit or unit to be tested. Beep and flashing LED indicate the presence of voltage (50VAC to 600VAC).

UT11B

- 1) Turn the unit on by pressing the power button once, the unit beeps and LED flashes two times. When the unit is under standby mode, the LED keeps flashing two times in every 1.5 seconds.
- 2) Place the probe tip on or near the circuit or unit to be tested. Beep and flashing LED indicate the presence of voltage (50VAC to 600VAC).
- 3) To turn off the beeper, you could press the power button once after turning on the unit, then you will hear a beep sound indicating the beeper is off. After the beeper is off, only LED will flash during checking. This way could save battery. Press power button to toggle between beeper mode and silent mode. Beep two times enters beeper mode, while beep one time enters silent mode.
- 4) In order to save battery, the unit will auto power off when it is not used for around 3 minutes. The beeper sounds 2 times continuously and then one long beep means the unit is power off.
- 5) Press and hold the power button for two seconds to turn the unit off, there will be one second long beep.

Battery Indication

UT11A: The beep sounds will still have but may be weaker if the battery is less than 2V.

UT11B: The LED will not flash when you turn the unit on or during checking if the battery is less than 2V. The beep sounds will still have but may be weaker.

Maintenance Battery Replacement

- 1) Disconnect the unit from the circuit.
- 2) One hand holds the unit. Place another hand's thumb on the probe cap as the figure below



UT11A

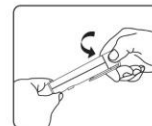

UT11B

- 3) Counter-clockwise twisting the cap off the probe slowly.
- 4) Replace the batteries (observe polarity).
- 2 x 1.5V AAA
- 5) Push back the cap.

Cleaning

Periodically wipe the case with a dry cloth do not use abrasives or solvents.

"END"

This operating manual is subject to change without notice.

Manufacturer:
Uni-Trend Technology (China) Limited
No.6, Gong Ye Bei 1st Road
Songshan Lake National High-Tech Industrial
Development Zone, Dongguan City
Guangdong Province
China
Postal Code: 523 808

Headquarters:
Uni-Trend Group Limited
Rm901, 9/F, Nanyang Plaza
57 Hung To Road
Kwai Tong
Kowloon, Hong Kong
Tel: (852) 2950 9168
Fax: (852) 2950 9303
Email: info@uni-trend.com
http://www.uni-trend.com

DIGINDT.IR

FGJ-NDT.IR

+982165565901

+982144584619

+989034119385

Tehran, Tehransar